

Mitchells Worktops

Worktops – Shower Panels – Sinks & Taps



HERNING SOLID WOOD WORKTOPS

PREPARATION – INSTALLATION – MAINTENANCE

***** TO AVOID BOWING YOU MUST STORE THESE WORKTOPS FLAT ON BEARERS *****

INTRODUCTION

Your new worktops are manufactured in Denmark in a modern factory using the finest quality materials. Please check them carefully as any defects must be reported prior to cutting and installation. The worktops have an "A" face sanded to 120 grit and a "B" face sanded to 80 grit. The leading edge is "A/A". For easy identification these instructions are always placed inside the packaging on the "A" face nearest to the leading edge.

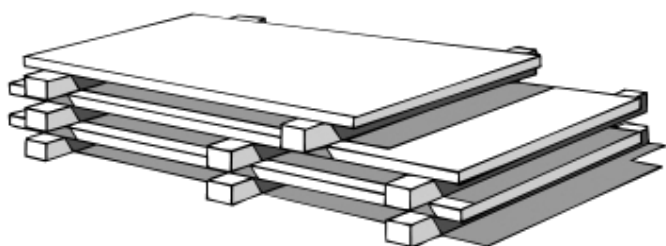

PREPARATION

Your worktops are manufactured with hardwood that is dried to 8% - 10% moisture content. They should only be installed when the moisture content in the room is 40 – 55% (normal) and the temperature is 18° C or above. Store the worktops unwrapped and flat on bearers in the room where they are being installed for a minimum of 24 hours, this will allow them to adjust to

the environment. Prior to fitting, the worktops must be treated with a good quality oil following the manufacturer's instructions. Apply at least two coats to both faces and all edges.

INSTALLATION

Wood is a natural product which will expand and contract according to the humidity levels. You must allow the wood to move naturally either by leaving a 5mm (minimum) expansion gap between the worktop and the wall, or by using fixings that hold the worktop in place, whilst allowing forwards and backwards movement. Where the worktops are joined you should consider how the movement of one section will affect the adjoining section.

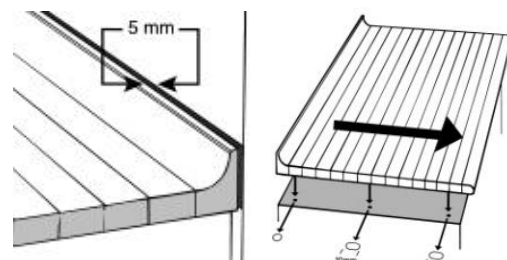

FIXINGS

Use 5mm diameter screws of sufficient length to penetrate 20 – 25mm into the underside of the worktop. When fixing through the washers. Fully tighten the screws and then release them a quarter turn. Metal L brackets should be slotted to allow forwards and backwards movement.

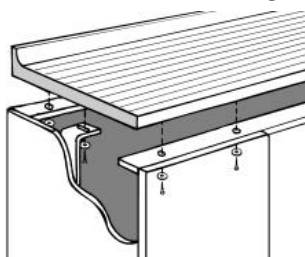

POSITIONING

Fixings should be spaced at 300 – 500mm centres and 50mm from the leading edges and short ends. Always fix at both the front and the rear. If the worktop is over 650mm you should use an additional row of fixings in the centre.

SOLID TOP UNITS

If the units have a solid top, fixing directly to this will underside and could cause bowing or splitting. Use 20 - material such as Hardboard at 500 – 600mm centres to underside of the worktop and the units.

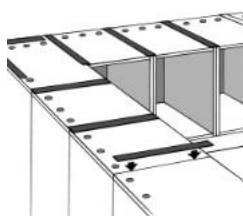

prevent the air from getting to the 40mm wide strips of 4-6mm thick create an air gap between the

Mitchells Worktops

Worktops – Shower Panels – Sinks & Taps

JOINTS

All joints should be a straight butt joint and not a masons mitre. Use a loose tongue or biscuits to align the joint, and worktop sufficient the depth with clear bolts to draw the two pieces together. 2 bolts in a worktop up to 650mm depth, 3 should be used if greater than 650mm. The joints can be sealed with silicone.

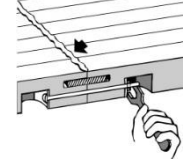
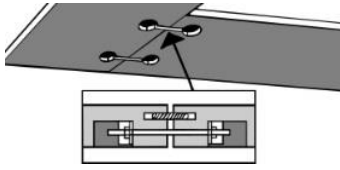

CUT-OUTS

Any cut-outs must be at least installed. Tap holes should be Cut-outs must not be made worktop, and there should between them. Remember times around the exposed Aluminium tape (50mm wide) being installed.

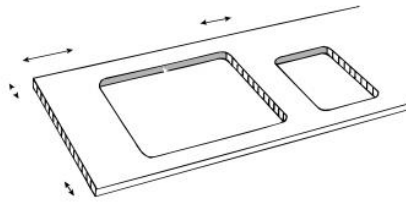

5mm larger than the hob or sink that is being 3mm larger in diameter than the tap base. less than 250mm from either end of the also be a minimum of 250mm distance that any cut-outs will need to be oiled several edges to give maximum protection. should also be applied to the edges if a hob is

APPLIANCES ETC.

Extra protection against heat and moisture ingress should be used on the underside of a worktop that covers an appliance such as a Washing Machine, Dishwasher, aluminium foil sheets are suitable for Tumble Dryer or Radiator. this and are readily available.

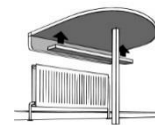

RANGE COOKERS/AGA/RAYBURN etc.

You must allow at least 50mm between the end of a worktop and a free-standing cooker. The ends of the worktop must be oiled copiously before installation and at least once a month after installation to prevent the wood from drying and splitting.



FREE STANDING AND UNSUPPORTED WORKTOPS

The maximum recommendation for worktops with an unsupported overhang is 250mm in the width and 400mm in the length. If any larger areas are unsupported (tables and breakfast bars etc.) metal T bars should be let in to the underside to add strength and prevent bowing.

MAINTENANCE

After installation another coat of oil should be applied to the top, and all exposed edges of the worktops. The oil must be fully dry before using the worktop, and within the first week of use any spills should be quickly removed and thoroughly dried. Further applications of oil should only be necessary twice yearly, however areas that are subject to wear and tear, or regularly get wet should be treated more frequently.



Cleaning should be with a soft cloth dampened with a mild soap and water solution. Never use detergents or washing up liquid as these will attack and remove the oil that is protecting the surface. Some oil manufacturers offer cleaning and aftercare products that are designed to work with their oils. We recommend using these where available.

